



LUISA RESIDENTIAL - GENERAL PLAN



Property information may be subject to errors and is not contractual. The surfaces expressed are approximate, being able to undergo modifications for technical reasons. Artistic Images Free Of Contractual Nature.



LUISA RESIDENTIAL - 22 JAZMÍN GARDEN

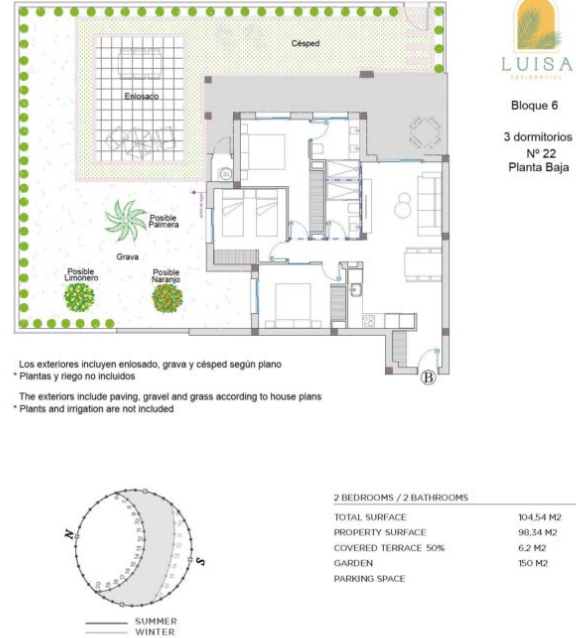

Property information may be subject to errors and is not contractual. The surfaces expressed are approximate, being able to undergo modifications for technical reasons. Artistic Images Free Of Contractual Nature.



Discover this exclusive private residential complex, designed to offer you maximum comfort and quality of life in a privileged setting. Located in Ciudad Quesada, just a few minutes from Alicante airport and with all the necessary services at your fingertips, this complex combines the essence of Mediterranean architecture with a modern and functional design.

The properties are available in two types: ground floor flats with a large private garden and first floor flats with a spectacular private solarium, ideal for enjoying the sun and tranquillity.

Each flat has 3 bedrooms and 2 bathrooms, as well as a storage room and parking within the development. The development offers communal areas designed for enjoyment and relaxation, with a large communal swimming pool and spacious green areas that create an atmosphere of exclusivity and wellbeing.

Live in a unique setting, surrounded by nature and close to the best beaches on the Costa Blanca, golf courses and a wide range of leisure and dining options.

www.euromarina.com

Urbanización Doña Pepa · Avda. Antonio Quesada, nº59 · 03170 Rojales (Alicante - España)



