

ADHARA RESIDENTIAL - MODEL JAZMIN A PENTHOUSE

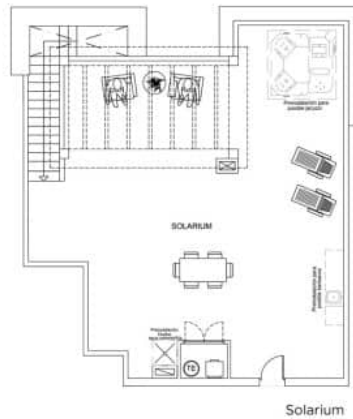

Solarium

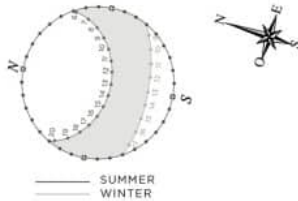

3 BEDROOMS / 2 BATHROOMS

TOTAL SURFACE	113.09 M2
PROPERTY SURFACE	101.89 M2
COVERED TERRACE	5.5 M2
SOLARIUM	98 M2
COMMUNAL PARKING SPACE	
STORAGE ROOM	

Property information may be subject to errors and is not contractual. The surfaces expressed are approximate, being able to undergo modifications for technical reasons. Artistic Images Free Of Contractual Nature.

www.euromarina.com

Urbanización Doña Pepa · Avda. Antonio Quesada, nº59 · 03170 Rojales (Alicante - España)

